

Grove Primary School Expansion



Background & Need

Grove Primary School is an existing 1 form entry Primary School for ages 4 to 11, with a pupil admission number (PAN) of 30 children per year group. The existing school is undersized to meet the demand arising from significant new build housing in Grove and Wantage, and it is proposed to expand the school to a 1.5 form of entry provision with a 45 pupil capacity per year group. It is also proposed to provide a 2 class nursery provision for ages 2-4.

The school is part of the Oxford Diocesan Schools Trust (ODST) Academy and the proposed expansion project is being delivered in conjunction with Oxfordshire County Council and the Oxford Diocesan Board of Education (ODBE). The project is funded via Section 106 monies generated by the surrounding residential development and it is envisaged that the proposed expansion will be needed by August 2028 ready for the new academic year.

It is proposed to submit a planning application in late September 2025.

The Proposal

It is proposed to expand Grove primary school from a 1 form of entry to a 1.5 form of entry provision, incorporating a new 2 class nursery provision to provide the community with a high-quality early years provision. The proposed solution is summarised as follows:

- Re-purposing of the existing school building to create an Early Years Foundation Stage (EYFS) incorporating a 2 class nursery.
- A new standalone primary school building is proposed to provide the new school entrance, school hall, classrooms and supporting accommodation.
- Associated landscaping and external spaces

Additional land is being provided by the developer to expand the school site as part of the wider masterplan to include a new synthetic sports pitch, additional playing fields, access road and parking.

The proposal has significant educational and community benefits to significantly expand, consolidate, and improve the quality of accommodation at the school, providing first class teaching accommodation and a new nursery provision.

Consultation Process

This consultation is seeking public comment on the proposed expansion of the school and design proposals. Comments can be submitted online via the ODST website or via a comments sheet in the school reception.

The consultation period will run from Monday 1st September to the 19th September 2025.

Visit <https://www.odst.org.uk/grovedevelopment> or scan QR code



Site location

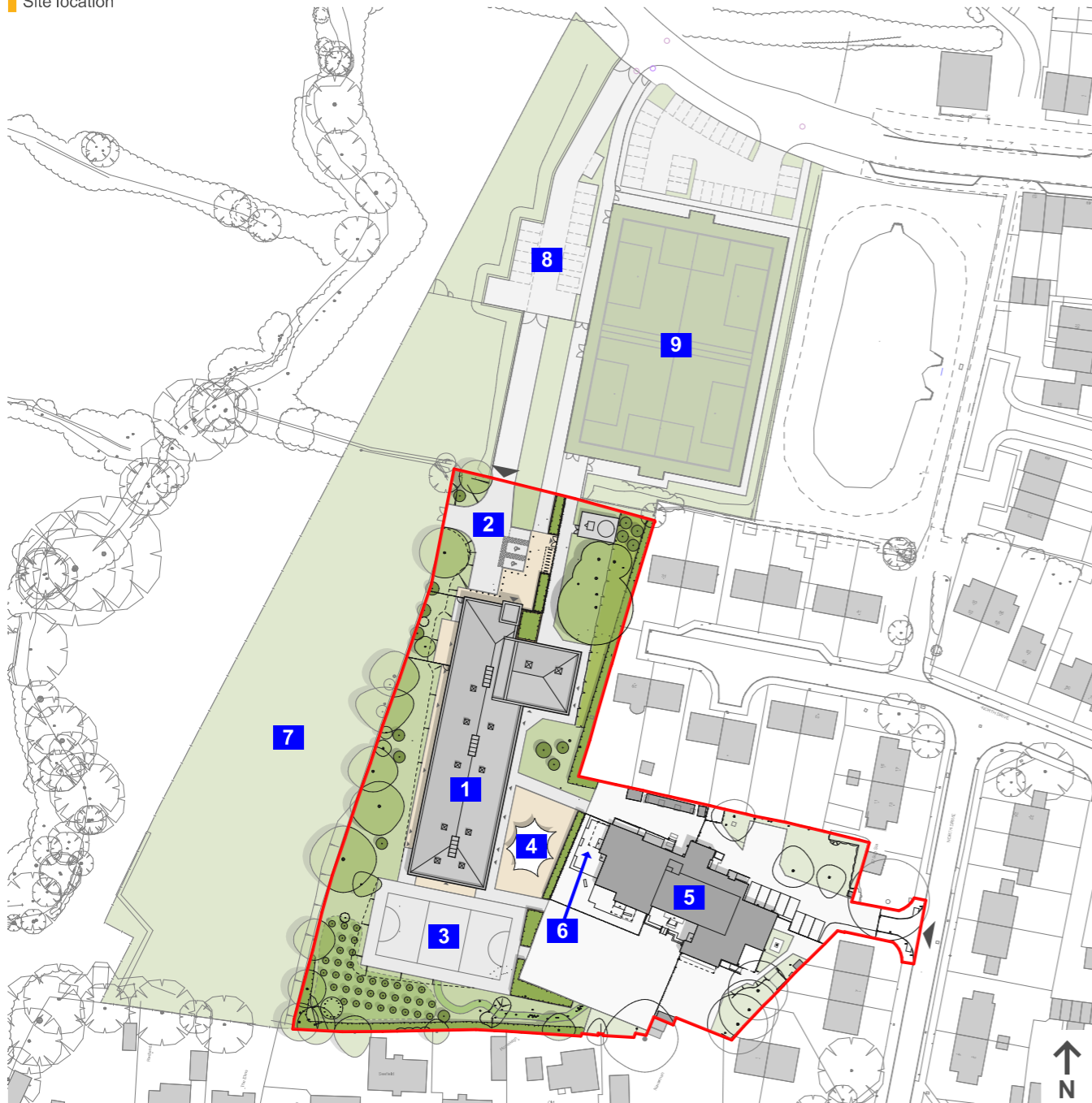

- KEY**
- | | |
|-----------------------------------------------------------------------------------------------------------|-------------------------------------------------------|
| 1 Proposed school building to accommodate Years 1 to 6 | 6 Proposed EYFS secure play area |
| 2 Proposed dedicated site entrance, parking spaces, cycle shelter and entrance plaza | 7 Playing field provided by Developer |
| 3 Proposed hard games court | 8 Parking area and area provided by Developer |
| 4 Proposed canopy structure for external dining | 9 Synthetic sports pitch provided by Developer |
| 5 Existing school converted to Early Years Foundation Stage (EYFS) incorporating two class nursery | |

